

ALUMINIUM DOOR SYSTEMS

COMPLETE ALUMINIUM DOOR WITH SCHÜCO PROFILE

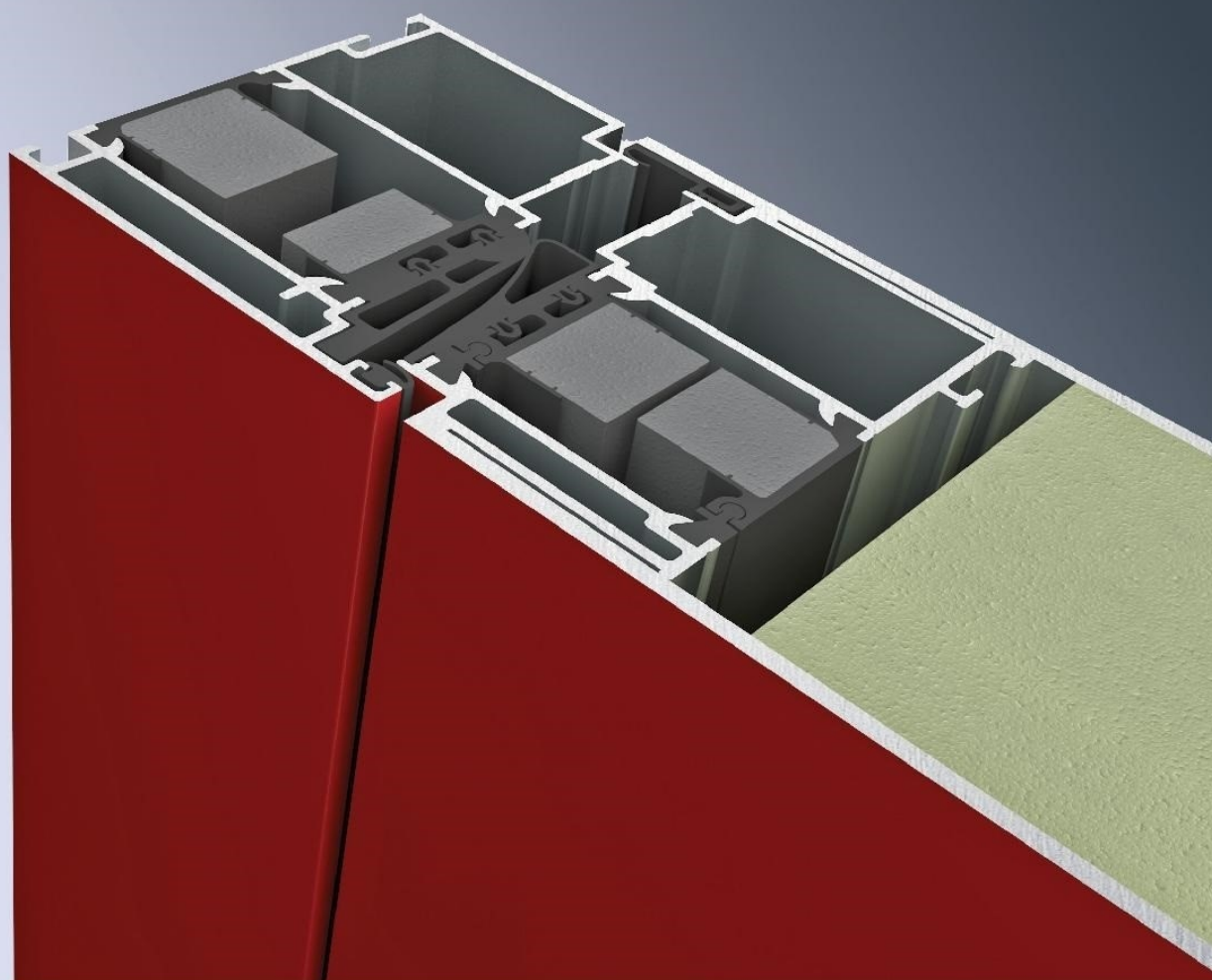

SCHÜCO

ADS 90.SI
ADS 75.SI

Schöne
portes - doors
Quality Products



Quality Products

SCHÜCO

The energy efficiency and the thermal factor play an ever significant role in the new or renovated houses and business buildings. The need for an entrance door which will comprise a beautiful design whereas at the same time provide best thermal insulation and security possible has brought the combination of Exclusive panels with Schüco energy frame! With ADS 90.S1 and ADS 70.S1 Schüco created a new low-energy line and a Model system for aluminium doors. The extensive insulation zones, the divided thermobreak, the excellent design and all the available optional accessories have ranked Schüco as the top company in the field of entrance doors worldwide. The Design and the Function of ADS Door Systems are in perfect harmony between them whereas with the combination of the advantages and Exclusive Panels an advanced technology (hightech) thermal factor is effected in the doors of today.



Security

The security of the door is a significant criterion for its selection. The robust SCHUCO ADS 75.51 and ADS 90.51 profiles, the heavy type hinges, the anti-burglar wedges, the multiple-point locks with safety level WK2 and WK3 in combination with the external aluminium sheet 3mm in width and the triplex window panes 4+4mm inside and out guarantee your safety providing a safety level up to WK 3. *



Design

The plain, non-ornamented SCHUCO lines with the flat surfaces combine with the new EXCLUSIVE panels which are distinguished for their high aesthetics and are characterized by the linear and at the same time modern design. The complete EXCLUSIVE DOORS with SCHUCO profile ADS 75.51 or ADS 90.51 are offered at a great variety in pattern and layout as well as in colour, window panes and accessories. The combination of inbuilt INOX in the aluminium, the window panes and the engraved lines put a modern finishing touch to the entrance of your house.



Quality

All the materials and components used in the construction of the door are SCHUCO. All SCHUCO components are certified according to the strictest German specifications for heavy-duty and intensive use with maximum structural loads. EXCLUSIVE panels are certified by the International Quality Security Standard ISO 9001-2008 and come with thermoinsulation.

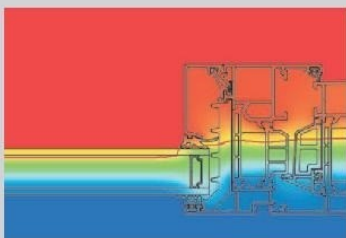

Thermal insulation

EXCLUSIVE complete door with SCHUCO profile ADS 75.S1 and AL 90.S1 offers an excellent thermoinsulation level certified by Rosenheim Institute. The specially designed chambers in the profiles with the foamy insulations in the central chamber and the thermointerruption provide for an insulating barrier between the internal and external temperature. The super insulating system of SCHUCO in combination with the low factor of the panel and the fourlayered window panes sets new standards with exceptional V-values. **

* The degree to which an entrance is protected from/against burglar attempts is determined by the security category WK which is designated by European standards. SCHUCO offers security levels from WK 1 to WK 3.

** V-value determines the level of heat loss through the door. The value is calculated between the internal and external side, per square metre and per hour, with a temperature difference between the interior and the exterior I.K.

Complete door with SCHÜCO profile ADS 90.SI



- Maximum thermoinsulation level and high aesthetics
- Flat surface inside and out
- Four-layered window panes for better thermoinsulation
- Triplex window panes 4+4 mm inside and out
- Aluminium sheet: 3 mm outside, and 3 mm inside
- Heat -penetration factor for door 120x220 cm
 $U_D = 0.90 \text{ W/(m}^2\text{K)}$ *see page 3*

Safety level Wk2 STANDARD *see page 3*

SCHÜCO

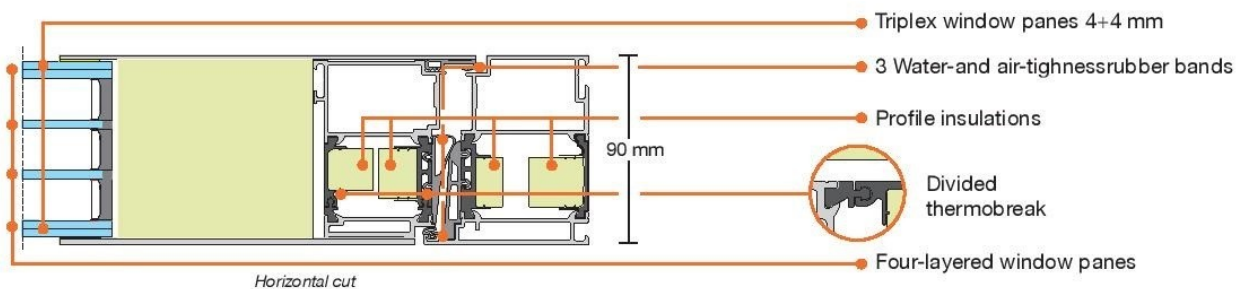

SCHÜCO expansion profile ADS 90.SI

The expansion profiles are the same width as the door frame and are used to cover openings or oblique points on or sideways of the door.

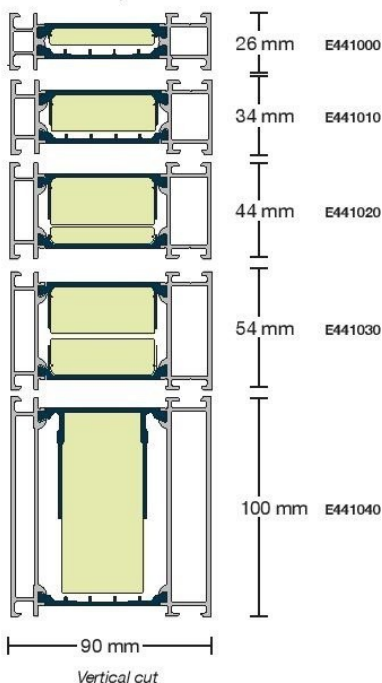

SCHÜCO floor insulation profile ADS 90.SI

The floor insulation profiles are used in new building constructions to insulate the floor.

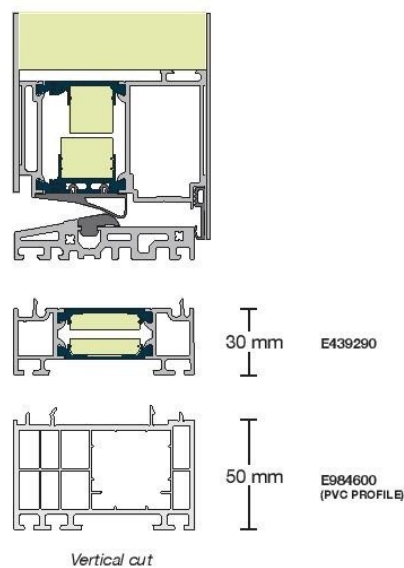

SCHÜCO ADS 90.SI standard equipment & options

Being energy standards oriented, SCHÜCO created the new series ADS 90.SI a new low-energy series which is a model system for aluminium doors. With a total profile width of 90mm, the extended insulation zones in combination with EXCLUSIVE panels and four-layered window panels create besides the beautiful aesthetic effect a door with the best thermal factor in the market. Aside from their energy efficiency, what is significant is that the products of the ADS 90.SI exclusive series offer maximum security, with the door security level being able to be modelled up to WK 3. Optionally, ADS 90.SI series has an availability of a wide range of original SCHÜCO accessories such as hidden hinges, fingerprint or camera.

- Dimensions of door in standard edition up to: Height: 2300mm, Width: 1090 mm
- Maximum Dimensions of Constructions of one-sheet door: Height: 3000 mm Width: 1400 mm
- Maximum Allowed Weight per sheet: 200 Kg
- Relief/Font lines and INOX decorations on the outside of the door
- The inside is flat (with window opening where applicable). Possibility for decoration on the inside.

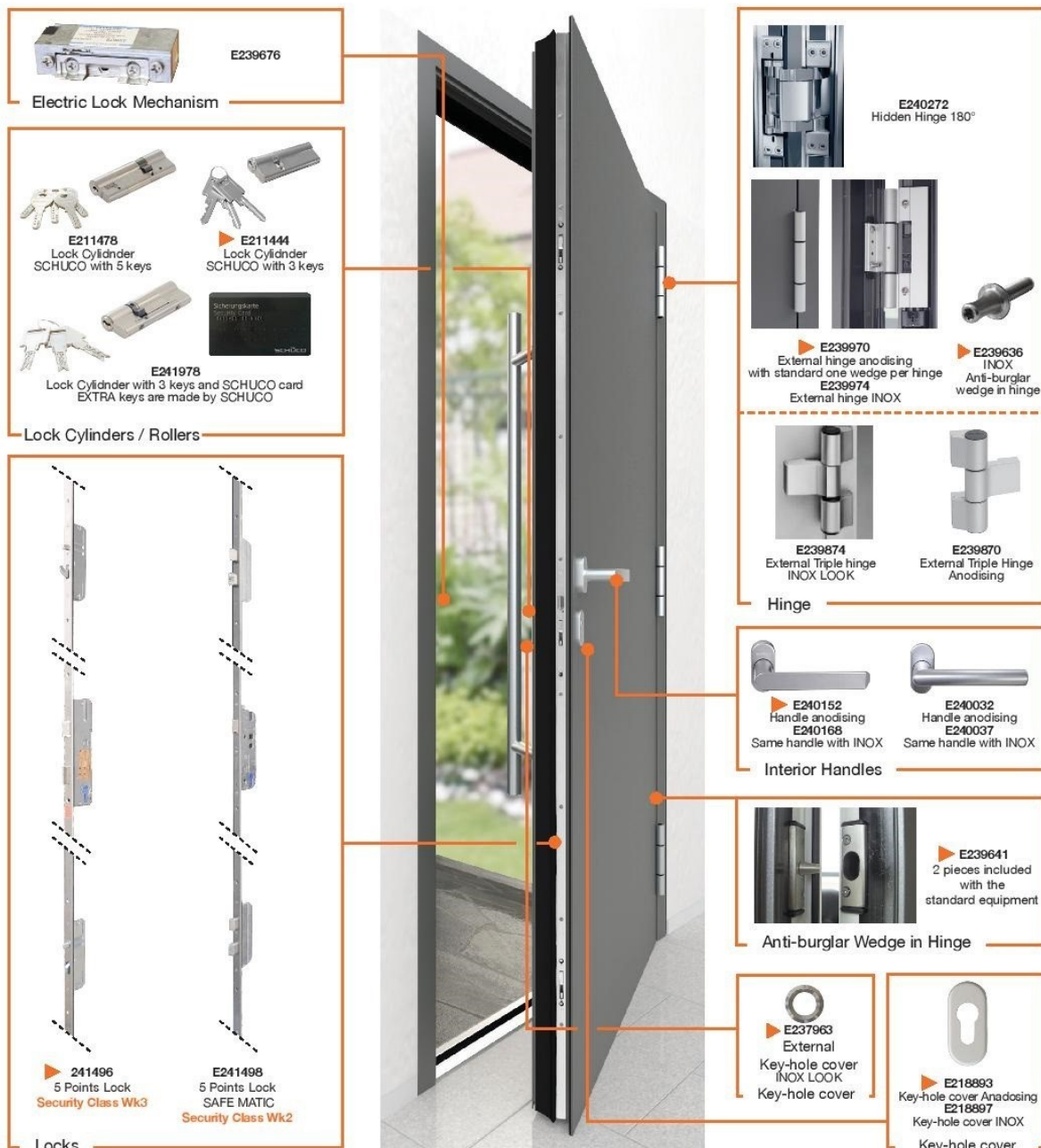

► included with standard standard equipment

Complete door with SCHÜCO profile ADS 75.SI

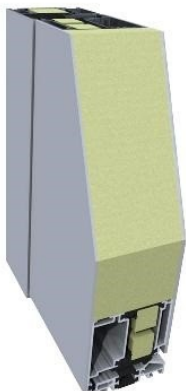

Internal facet

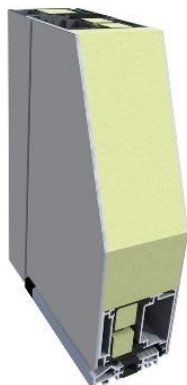

External facet

- Maximum thermoinsulation level and high aesthetics
- Flat surface inside and out
- Four-layered window panes for better thermoinsulation
- Triplex window panes 4+4 mm inside and out
- Aluminium sheet: 3 mm outside, and 2 mm inside
- Heat -penetration factor for door 120x220 cm
 $U_D = 0.87 \text{ W/(m}^2\text{K)}$ *see page 3*

Safety level Wk2 STANDARD *see page 3*

SCHÜCO



$U_D = 0.87 \text{ W/(m}^2\text{K)}$

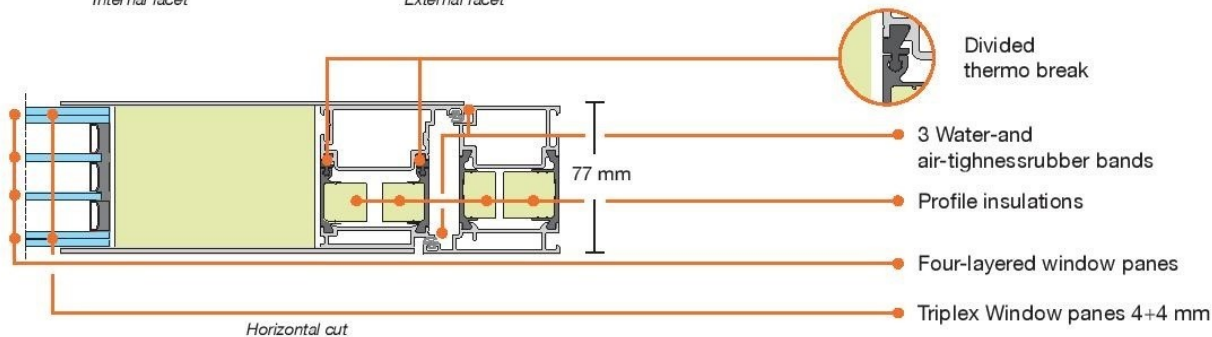

SCHÜCO expansion profile ADS 75.SI

The expansion profiles are the same width as the door frame and are used to cover openings or oblique points on or sideways of the door.

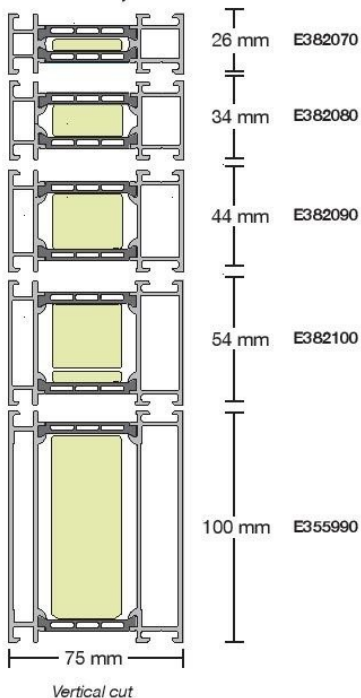

SCHÜCO floor insulation profile ADS 75.SI

The floor insulation profiles are used in new building constructions to insulate the floor.

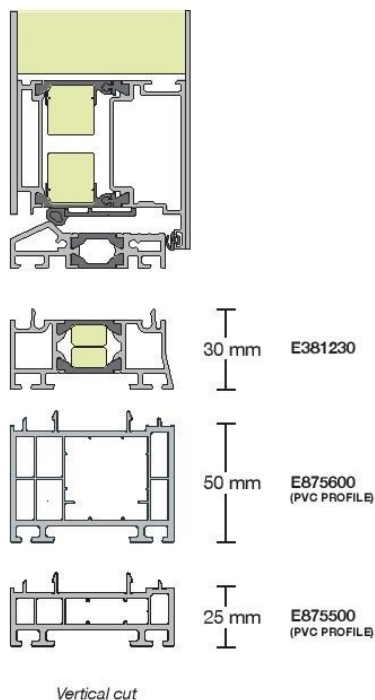

SCHÜCO ADS 75.SI standard equipment & options

An elegant door lends a distinct style to your house however this in itself is not sufficient. The combination of the SCHÜCO ADS 75.SI and the EXCLUSIVE panels created the perfect effect. With the thermoinsulation Factor modeled at only 1,17 W/ (m²k), the security level to maximum and the perfect linear design we are certain to meet all your needs! ADS 75.SI series is available at a variety of optional accessories by SCHÜCO offering numerous possibilities and on top of everything the advantage of additional/extra safety and sturdiness. In parallel, the new generation of external hinges in combination with the hidden components satisfy the most specialized demand in design and comfort/ convenience.

- Door dimensions in standard edition up to: Height: 2300mm, Width: 1090 mm
- Maximum dimensions of construction of one-sheet door: Height: 3000 mm Width: 1400 mm
- Relief/Font lines and Inox decorations on the outside of the door
- Inside Flat (with window opening where applicable)
- Decoration on the inside is also possible on request but when the design comprises Inox decorations, the aluminium sheet to be used on the inside must be 3 mm).

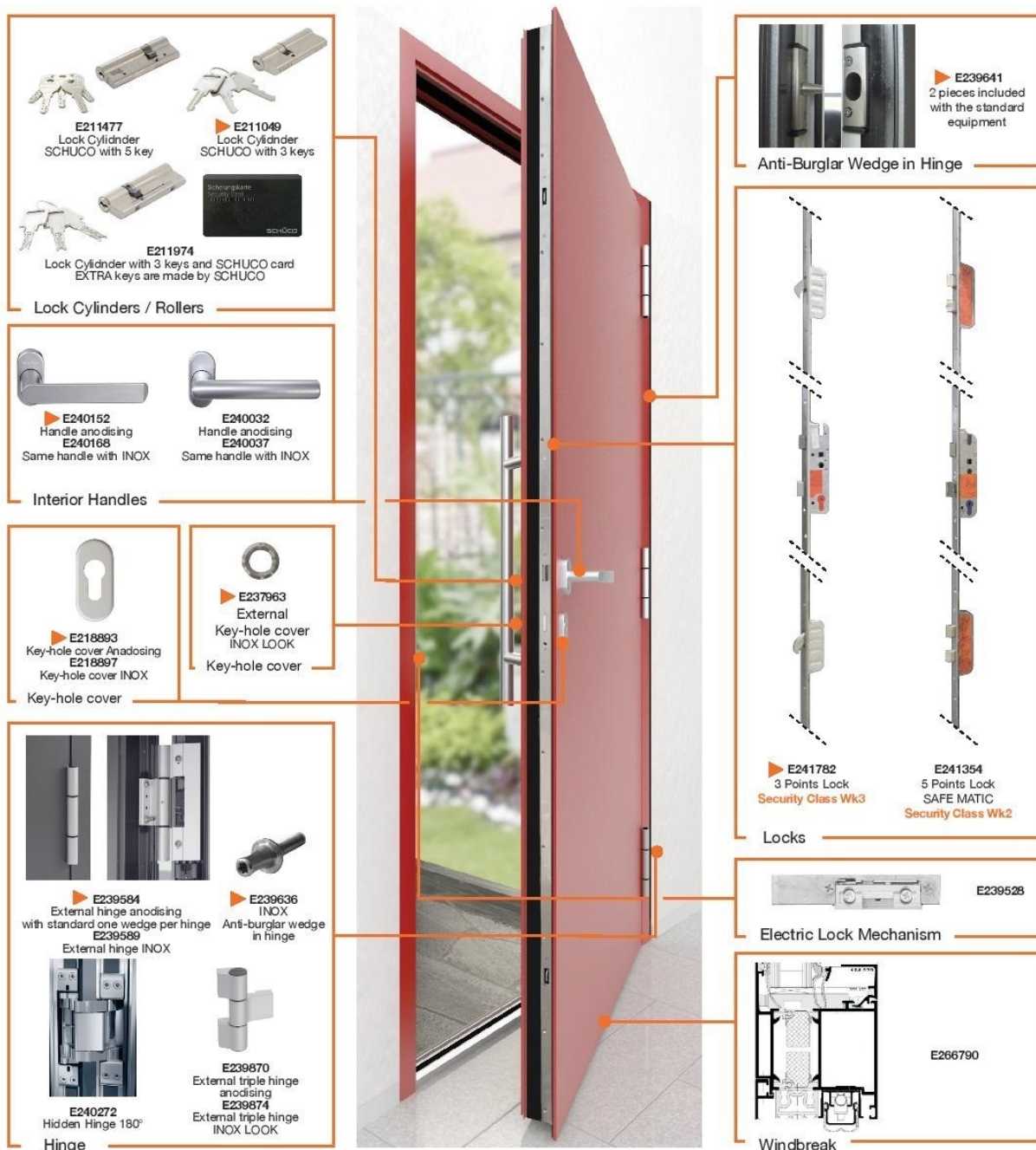

Optional Equipment for SCHÜCO ADS 90.SI & 75.SI



E238828/75 for ADS 75 SI
E238828/90 for ADS 90 SI

Opening with fingerprint

With fingerprint scanning, SCHÜCO offers a biometric system inbuilt in the profile of the door allowing for safe access against unwanted/undesirable visitors. The door can be unlocked through fingerprint identification. The method provides the highest possible protection level and the possibility of system violation is non-existent.



E262019

Magnetic Contact

Door condition indication (open-closed)
Possibility of connection to an alarm mechanism, with luminous indication and sound warning.

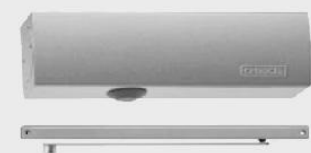

E212457 Classic Mechanism

Return Mechanism

The Return Mechanism ensures the door closes automatically after opening. The force and speed of closing can be regulated/adjusted to your needs



E212763 Linear Mechanism



E561 Spyhole

Spyhole

Inox lock Hafele spyhole 200°
(between 39mm and 75mm)



E262910

Camera over door

The camera is placed on the upper horizontal profile of the door frame. It can be connected to a TV set, a computer or a wi-fi net.

Selection of frame type for SCHÜCO ADS 90.SI & 75.SI Door

Select the frame type you desire and fill in the code in the corresponding box on the order form. In the case of two-sheet frames you will be asked to select which sheet will open first.

L left door sheet

R right door sheet

Selection of window panel type for fixed and skylights windows

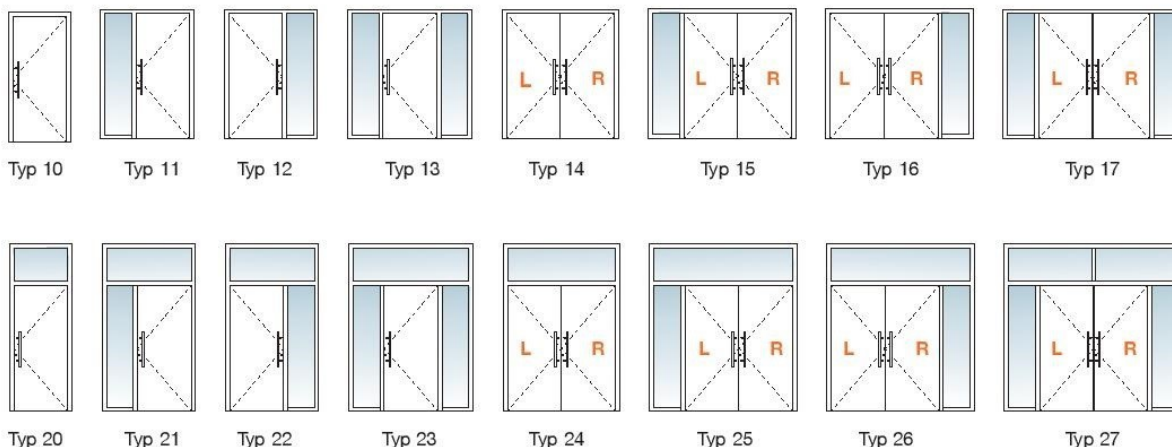

Select the Type of Windows for Sidelights and Transoms SCHÜCO ADS 90.SI & 75.SI

Select the type of the windows that you wish when your door is with sidelights or transom and enter the correct code in appropriate box on the Schüco order form. Choose between double windows panes 6mm, triple windows panes 4mm or 8mm triplex. Furthermore, select sandblasting or transparent glasses for your door. All of your options are with low-e glasses for the best thermal insulation.

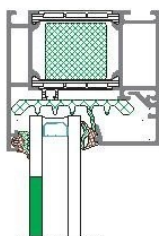

G1

energy-efficient 6 mm
transparent 6 mm
total thickness 24 mm
(visible inside)

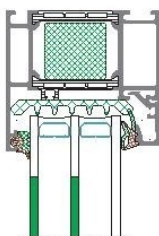

G3

energy-efficient 4 mm
energy-efficient 4 mm
transparent 4 mm
total thickness 44 mm
(visible inside)

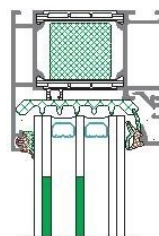

G5

energy-efficient 4+4 mm (triplex)
energy-efficient 4 mm
transparent 4+4 mm (triplex)
total thickness 44 mm
(visible inside)

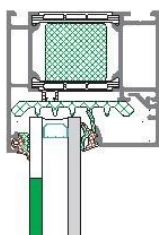

G2

energy-efficient 6 mm
sandblasting 6 mm
total thickness 24 mm
(not visible inside)

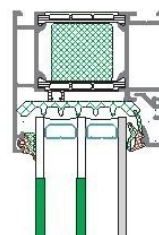

G4

energy-efficient 4 mm
energy-efficient 4 mm
sandblasting 4 mm
total thickness 44 mm
(not visible inside)

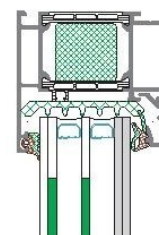

G6 *

energy-efficient 4+4 mm (triplex)
energy-efficient 4 mm
sandblasting 4+4 mm (triplex)
total thickness 44 mm
(not visible inside)

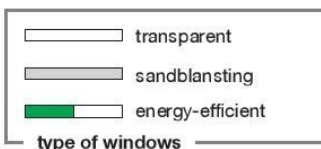

* The same glass is used for the panel. It is proposed the glass panel to have the same type of glass with the fixed or the skylight so that both have the same color.

Handles SCHÜCO

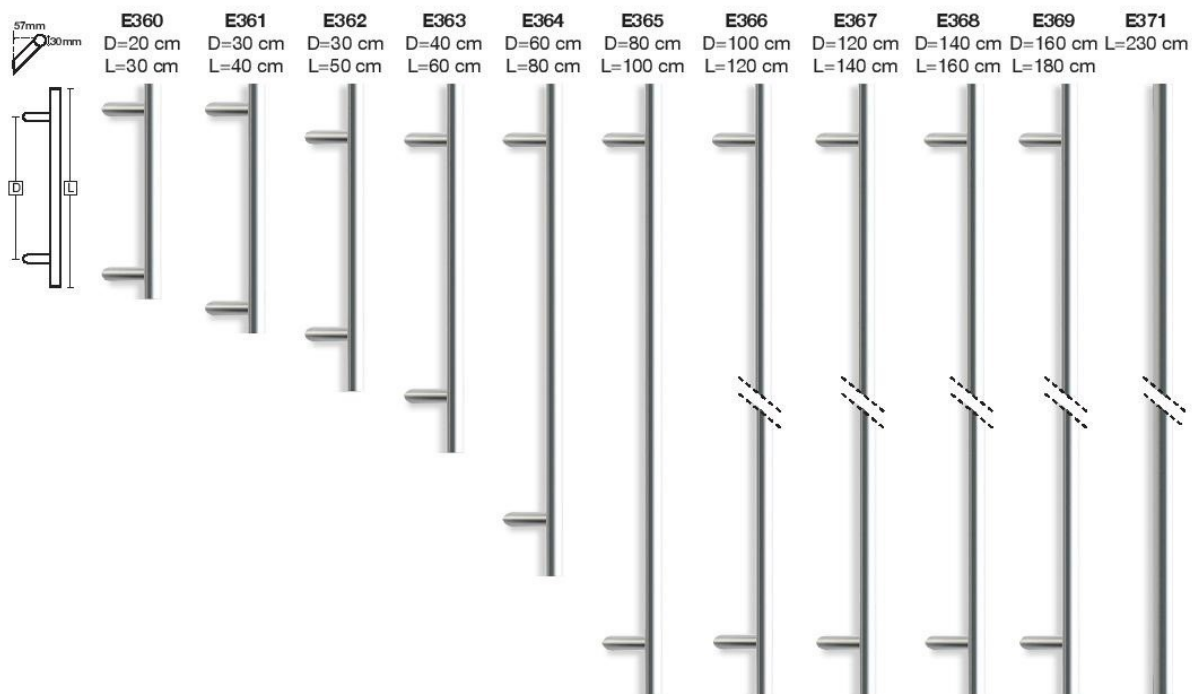

Handles inox 316

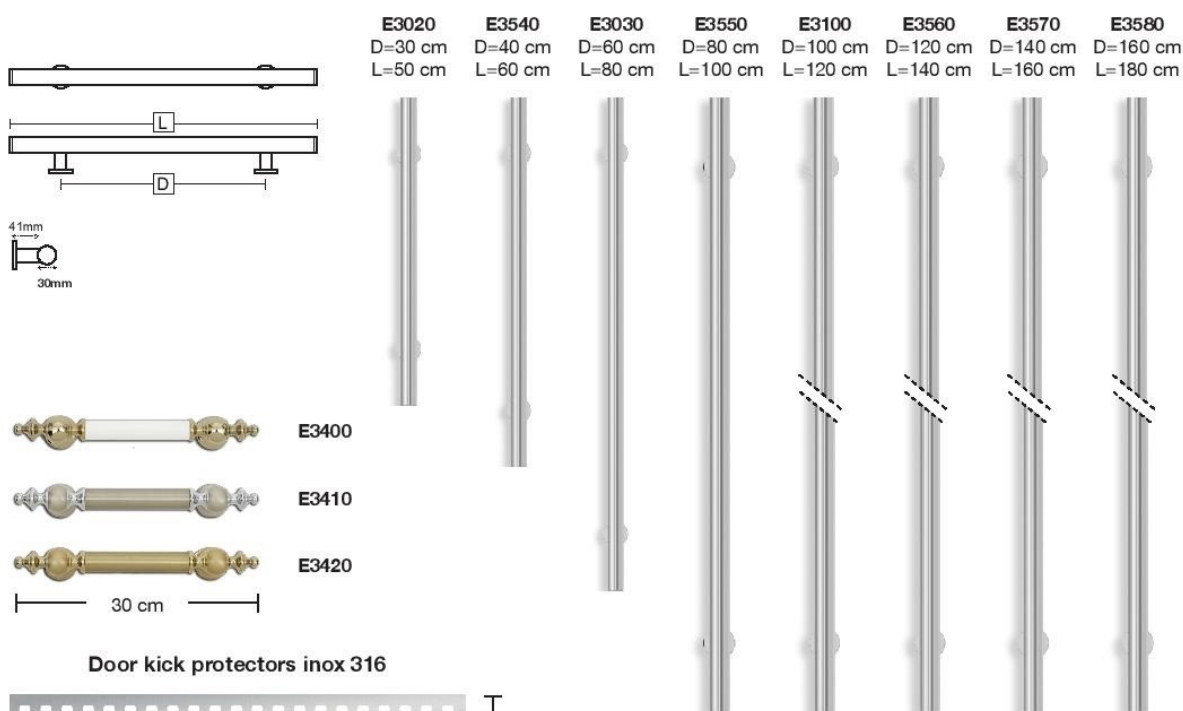

Door kick protectors inox 316

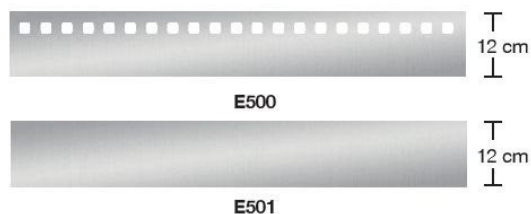

Numbers from Inox 316 on the door







L 100



L 101



L 110



L 110



L 120



L 121



L 123



L 124



L 130



L 140



L 140



L 150



L 160



L 161



L 162



L 165



L 170



L 171



L 180



L 180



L 190



L 200



L 210



L 211



L 212



L 220



L 222



L 224



L 230



L 231



L 240



L 241



L 241



L 250



L 251



L 260



L 261



L 270



L 280



L 290



L 300



L 301



L 301



L 302



L 303



L 310



L 311



L 312



L 313



L 320



L 330



L 331



L 335



L 337



L 340



L 350



L 351

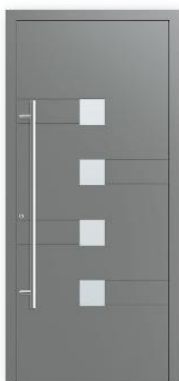

L 360



L 361



L 370



L 371



L 372



L 380



L 381



L 383



L 385



L 390

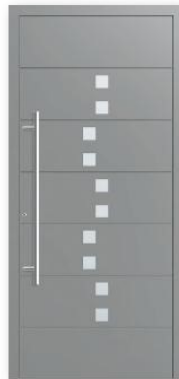

L 391



L 392

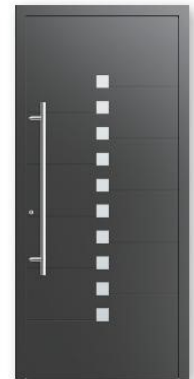

L 393



L 400



L 401



L 401



L 410



L 420



L 421



L 430



L 431



L 432



L 435

SCHÜCO

Schöne
portes - doors